

4.Site-Specific Singing

2018

Made in collaboration with Annelie Koning, Burkhard Körner, Cécile Tafanelli, Duncan Robertson, Ivan Cheng, Lies Beijerinck, Marcel Smit, Marc Alberto, Maria Montesi, Marjolijn Roeleveld, Moira Theresia Mirck, Petra Pieck, Rutger de Groot, Thom Driver

In Site-Specific Singing, singer(s) will observe and explore the space, and the relation with the audience, and will sing with it. The building has openings and cavities like our body or instrument. There are many elements to sing with: small rooms to hide the voice, doors that open and close, echoes back from the space, strange reverbs from metal objects, pipes to transmit the sound and warmth, etc. Voices and breath will be transmitted/accumulated from here to there, corridor, staircase, elevator, ceiling, underground tunnel, insulation pipes, etc.

Maybe it will change a way of how to look at the building. Maybe it will make more sensitivity in listening.

Maybe the audience would try listening to bed-spring at home, or try singing in the public space to hear the echo?



←↑ Performance at Dokzaal (Original duration 40minutes)

Video documentation 00:06:17: <https://vimeo.com/293800506>

4-2.Scores for Site-Specific Singing

Site-Specific Singing 20180612: instant performance with everyone

Schedule

Part1:

12:00 Warm-up "Ring"

Part2:

12:10 Come back to the hall. Check the paper. Split into 6 groups. Do the practice.

12:19sharp Come back to the hall

12:20 Performance!

12:30 End

PART1:

About "Ring"



PART2:

Performance time frame (The time is a sort of rough aim)

12:20 **Group1** and **Group2** starts, which stops after hearing **Group4** starts

12:21 **Group4** starts, but only "the wooden café-hall doors" piece, which stops when **Group3** opens the door.

12:22 **Group3** interrupts **Group4** and starts walking and singing.

12:24 **Group3** comes back to the café. Till then **Group4** is ready for kitchen piece and piano piece.

12:24 **Group4** first does kitchen piece and then piano piece

12:26 **Group5** starts and **Group4** stops.

12:27 **Group6** starts and **Group5** stops.

TASKS... *** means "leader", who knows more about Site-Specific Singing, so they can put extra information

Group1: Cecile*, Natasha, Bin

Group2: Thom*, Duncan, Marnie, Mavi

Group2:

Use 4 corners of the downstairs of the hall. One person at one corner.

Transmit a song (Material: calling voice) in one direction and keep the rotation. The song will naturally mutate.

Group1 and **Group2** do the tasks at the same time, but as separate groups.

Group3:

Open the wooden café-hall doors.

Walk fast and sing loud simultaneously (Material: Any vowel with long-tone or short-tone, and everyone tries to have synched rhythm.), from *the wooden café-hall doors* > *café* > *stairs* > *DJ-room* > *Toilet-corridor* >

Emergency-staircase > *Emergency door*(Don't worry, it's not alarmed) > *Studio-entrance* > *corridor* > *The hall* > *spread to the 3 staircases, go up and down* > *come back to the café*.

When there are stairs, use high pitch when you are higher, and use low pitch when you are lower.

← Instructions prepared for a workshop

(This is an instruction for a workshop-style presentation of Site-Specific Singing at Dokzaal. Participants were around 20 people. I gave a short workshop for 20 minutes after the explanation with this paper, and we did one performance altogether for 10 minutes.)

→ One of the scores I made during research workshops with singers for Site-Specific Singing at Dokzaal 2018

< SIMPLE SOUNDS / VOICES >

* CURTAIN CHECK

1 person A ~

↓
open the curtain (call)

↓
2 person A ~

↓

3 ppl sing in sync with the space

• balcony
• corner
• window
• staircase
• under the staircase
• behind something
• a door
• a glass
• centered
• in the storage
• to a pipe
• to reach other
• to everyone
• to the ceiling
• to the floor



• The hall → café → downstairs → toilet → emergency staircase
→ entrance → corridor → the hall

< RESONANCE CHECKS >

1st: downstairs (the dark stage)

2nd: the hall

< CALLING >

What are the calling sounds?

1st: downstairs (the dark stage ↔ toilet corridor ↔ toilets)

2nd: hall (café ↔ hall ↔ corridor)

< TRANSMISSION >

Hall → café
Corridor → the dark stage
Entrance → toilet corridor

• words
• sounds
• calling
• numbers

quickly
smoothly

	TOILET & CAFE	notes	AUDIENCE	HALL	NOTES
14:50	Allegro turns into Impro	• one by one moment • altogether moment • door control by (M) • sometimes by others	Start entering ① café ← (M) Café → hall → (M) complete = door closed	2-3 singers waiting @ balcony Start calling /echoing (M)	
15:10	STOP by (M) Sing from the café windows → move to the hall Keep singing	• Reverbed voice by pedal		15:05 15:13 All singers gather @ The wall Synched movements Singing 15:30 Split into 3 groups One group upstairs Two group downstairs 15:37 Gradually spread to downstairs and make "RING" Someone in the hall starts and transmit	• as a flock • slow, but sometimes fast • change volumes • For PIPE MOVEMENT, respect & help • synched in group compared as a whale
				Start Walking Start Overlapping Become One	• keep the distance
				15:45 End	

4-3. Scores for Site-Specific Singing

→ Drawings

When I organized rehearsals or workshops for Site-Specific Singing performance, I prepared such drawings, in order to give an idea to singers about how to do Site-Specific Singing. I also drew them directly on the wall of the exhibition spaces, to give visitors an idea about how they also could do site-specific singing/listening at the site.

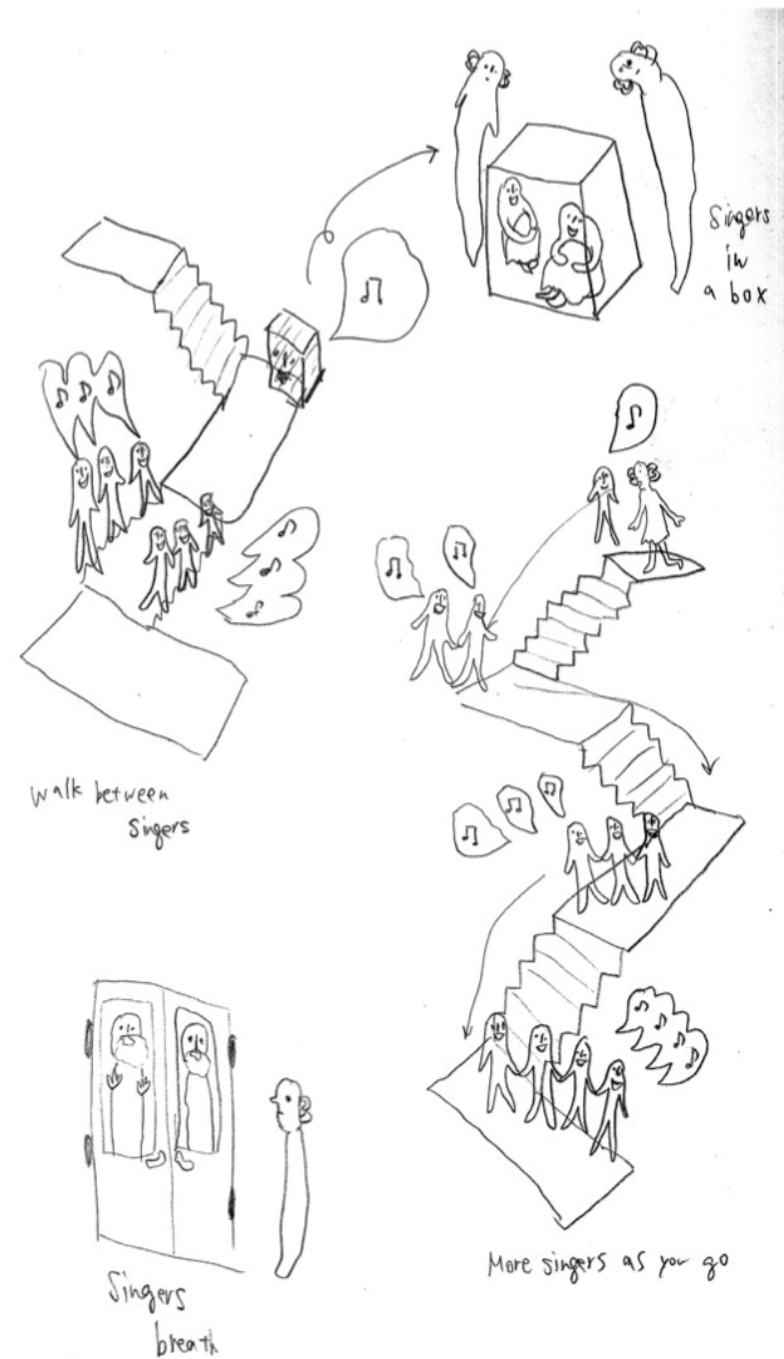
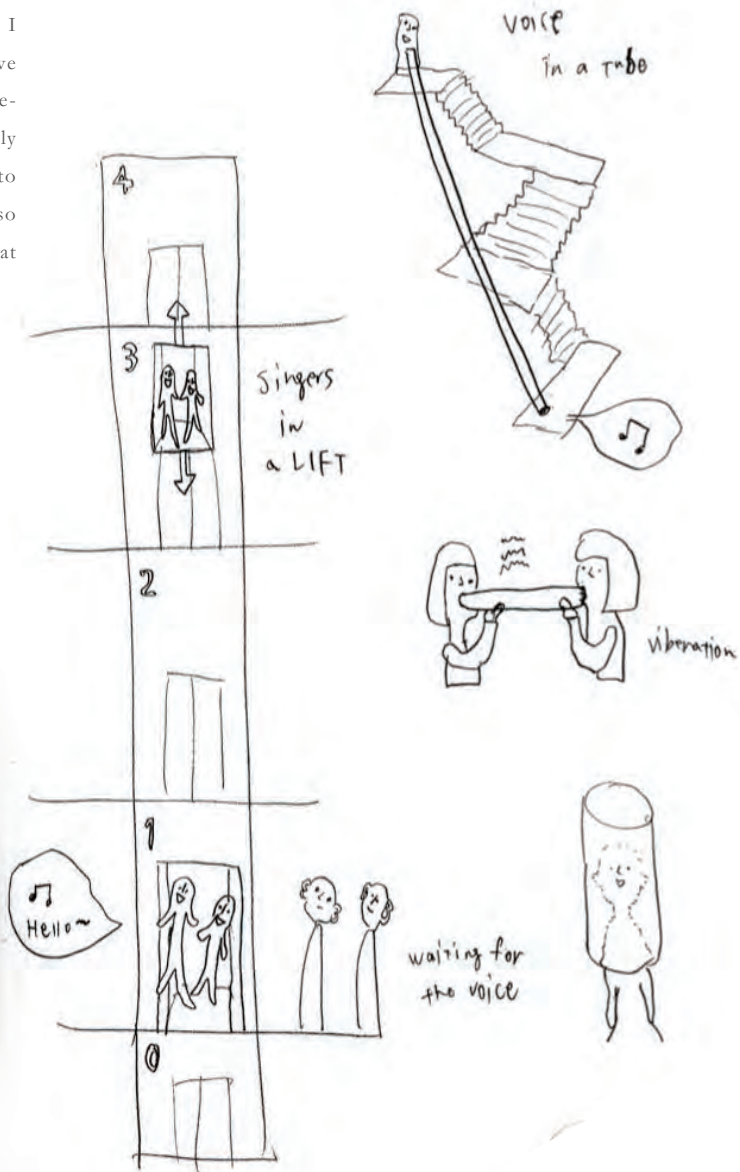

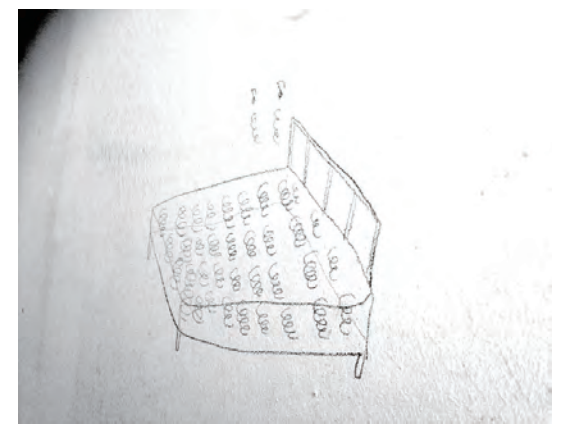
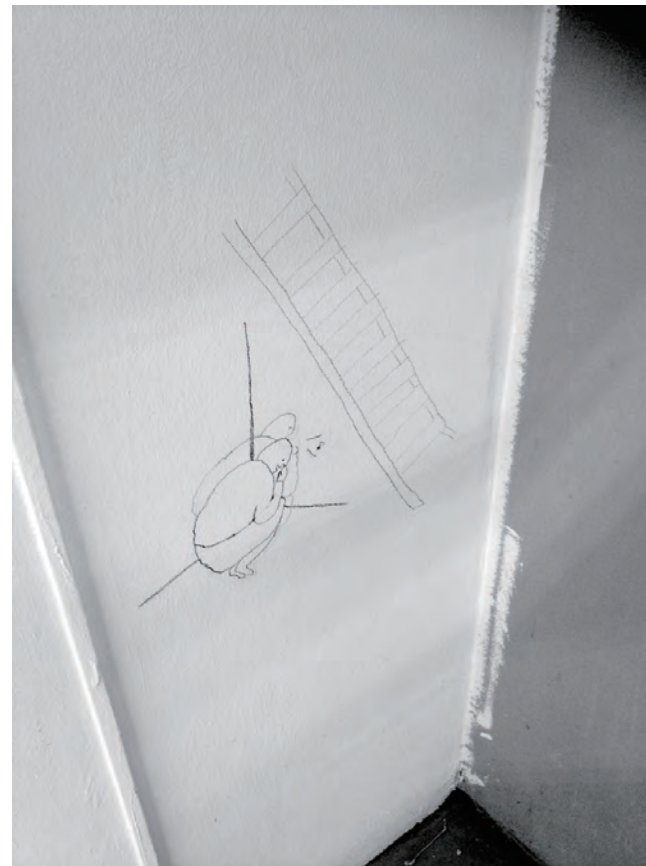
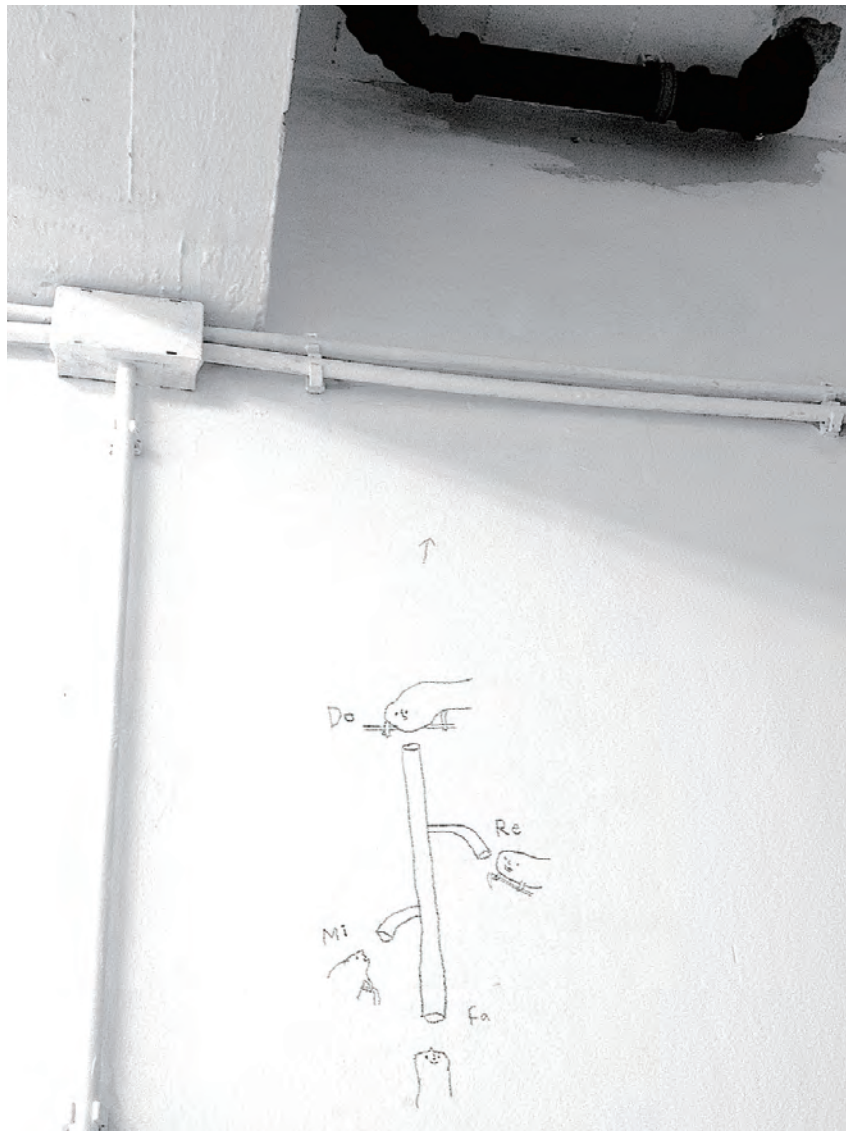

4-4.
Suggestions for Site-Specific Singing on site, drawn on a wall

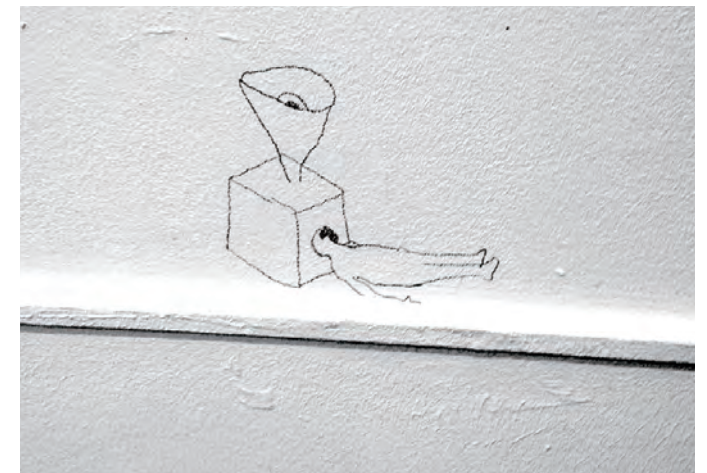
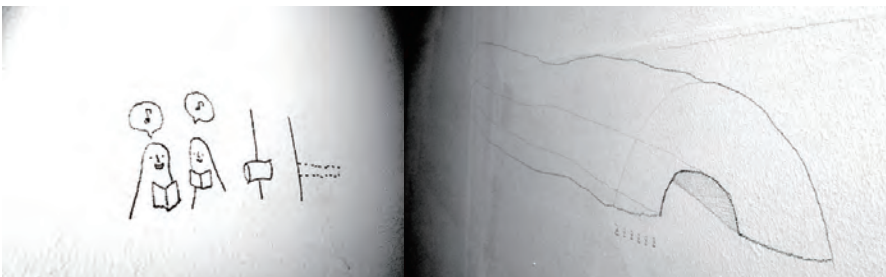



↑ Singing with tin plates ©Est-Nord-Est, artists residency / Jean-Sebastien Veilleux photographer



↑ Performance in tunnel, City Circles 2019, photo: Melanie Lemahieu



↑ Singing with the building ©Est-Nord-Est, artists residency / Jean-Sebastien Veilleux photographer



↑ Singing in a playground, City Circles 2019



↑ Singing at Oudekerk, Amsterdam, 2018, with Annelie Koning and Moira Mick

4-5.Site-Specific Singing at various locations

4-6.Site-Specific Singing at various locations



↑ Researches at WOW Amsterdam (Video Documentation 10minutes):
<https://vimeo.com/266516534>



↑ Performance at WOW Amsterdam, 2018
<https://vimeo.com/363628753>



↑ Singing in an elevator, workshop at the Inter Arts Center, Sweden



Singing with national siren system in the Netherlands↑



↑ Research at Nassaukerk with Genetic Choir, 2017